

Blindspace® C110x130 & C110x50
for SHY 85/60 ZIP 240v

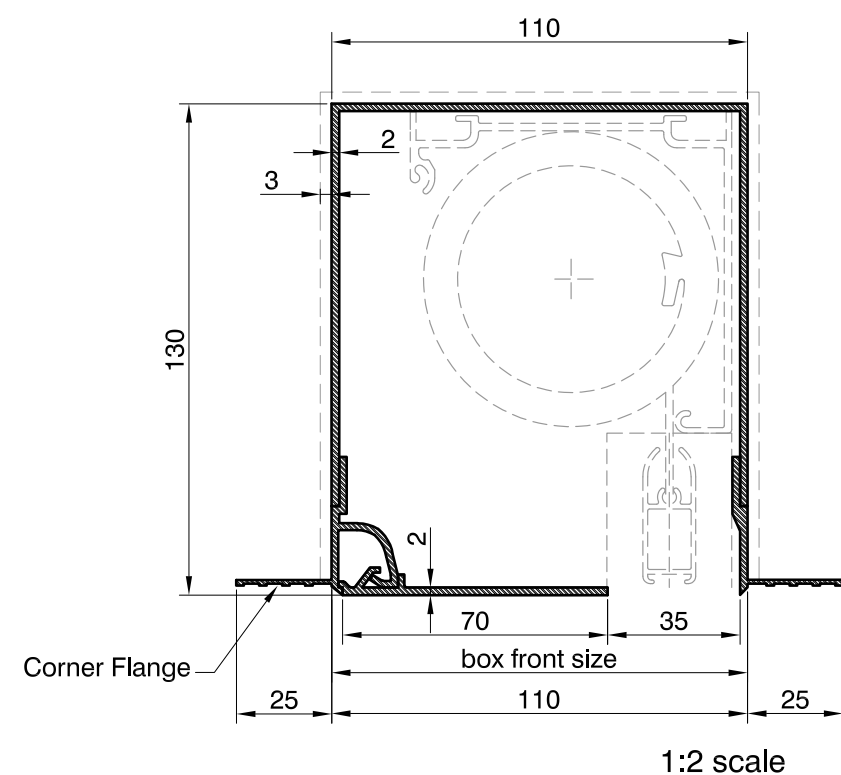

C110x130 R
Head Box

SAMPLE INSTALLATION DETAIL

INSTALLATION NOTE:
Make sure there is space for window/door handles.
Boxes and blinds can also be mirrored in vertical plane
for opening towards the room.

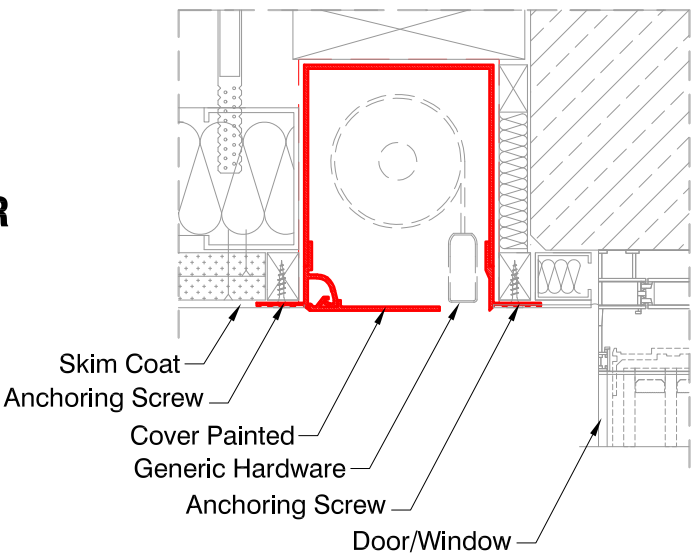

SKIM COAT FLANGES
LOCATION OPTIONS

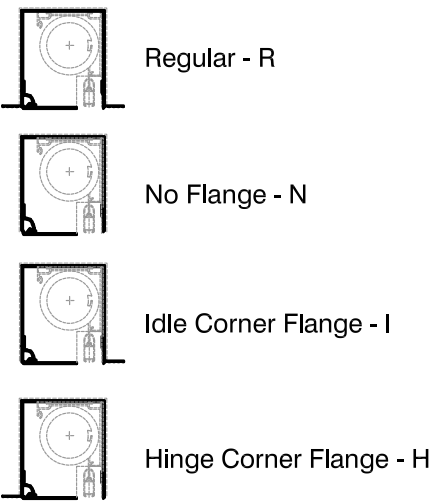

PRODUCT REFERENCE

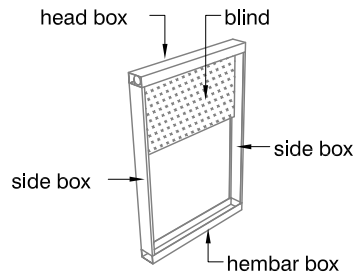
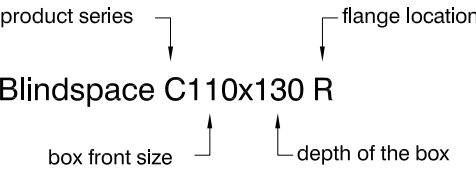

Top down configuration of blinds is shown.
Bottom up configuration is also possible.
For bottom up configuration the frame layout
should be mirrored in horizontal plane.

FRAME LAYOUT OPTIONS

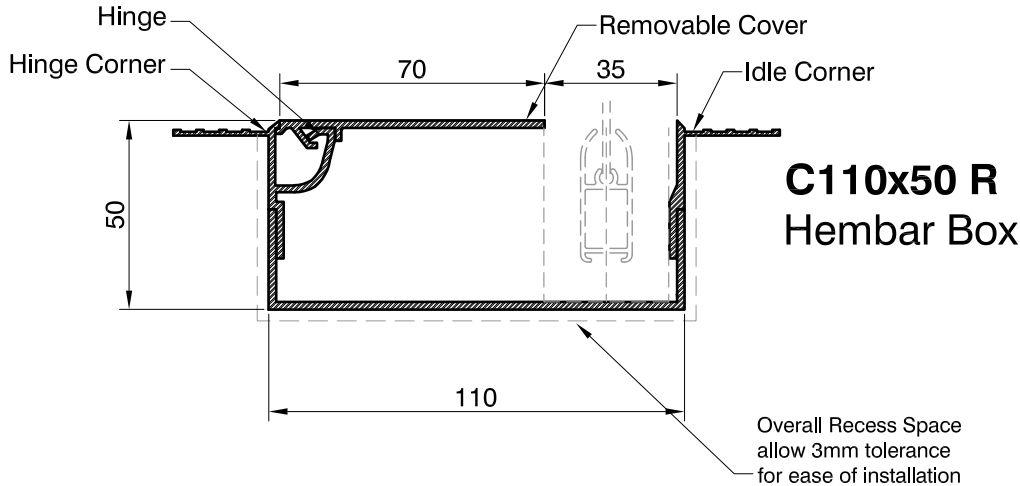
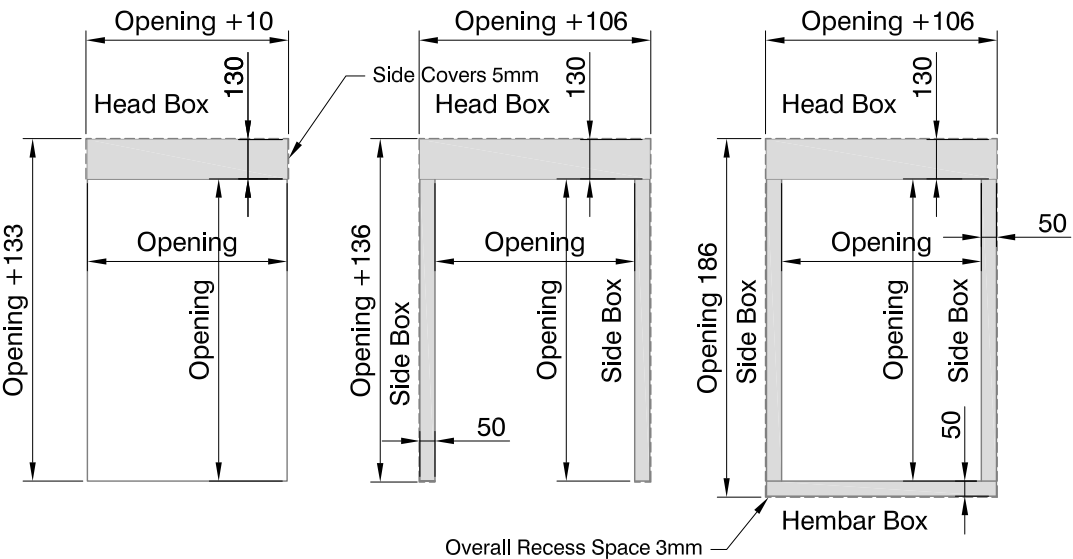

C110x50 R
Hembar Box

Product	Blindspace C110x130
Description	Recessed aluminium boxes and covers designed to conceal window blinds.
Material	Anodized Aluminium, grade: front plate: EN 6063 T6 back plate: EN AW-1050A H14/H24
Finishes	- Unfinished for site painting - Primed for site painting - Pre-finished to RAL colour
Blind sizes	Blind Sizes to fit inside the box: SHY 85/60 ZIP 240v with 36mm hem bar Exact size depending on fabric and hembar selection. Opening Width max: 2900mm Opening Height max: 3000mm Area max: 6,4m²
Installation	Boxes should be fixed on both sides. The finished plaster level should be flush with chamfered edge. Anchoring countersink screws through skim coat flanges are recommended.
Drawing	Custom Blindspace Boxes C110x130 for Window Blinds
Item name	C110x130, C110x50
Date	September, 2018
Notes	Dimensions in mm Do not scale from drawing
Drawn by	M. Kozak, B. Dzieza
Approved	A. Sundelin
Revision	R-0: first issue R-1: naming update

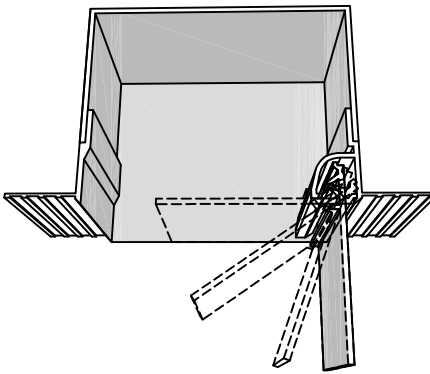

Print date	2018-9-27
Print file	blindspace c110x130 for windows with shy 85-60 zip 240v 36 hem v10.dwg
Page size	ISO A3 420x297
Remarks	ZWE